

MSC

9.748 SF FORMER CVS AVAILABLE FOR SUBLEASE

WASHINGTON SQUARE WEST
PHILADELPHIA, PA



11TH AND
SOUTH STREETS

11TH AND SOUTH STREETS



PROPERTY DETAILS

- ▶ 9,748 SF corner retail at 11th and South Streets
- ▶ Three-level public parking garage above ground floor retail
- ▶ Dense residential community with strong national co-tenancy

DEMOGRAPHICS

EST. POPULATION
1 mi 100,754
3 mi 471,058

EST. AVERAGE HH INCOME
1 mi \$113,405
3 mi \$85,498

JOIN NEIGHBORING TENANTS





FLOOR PLAN

SOUTH STREET

IITH STREET

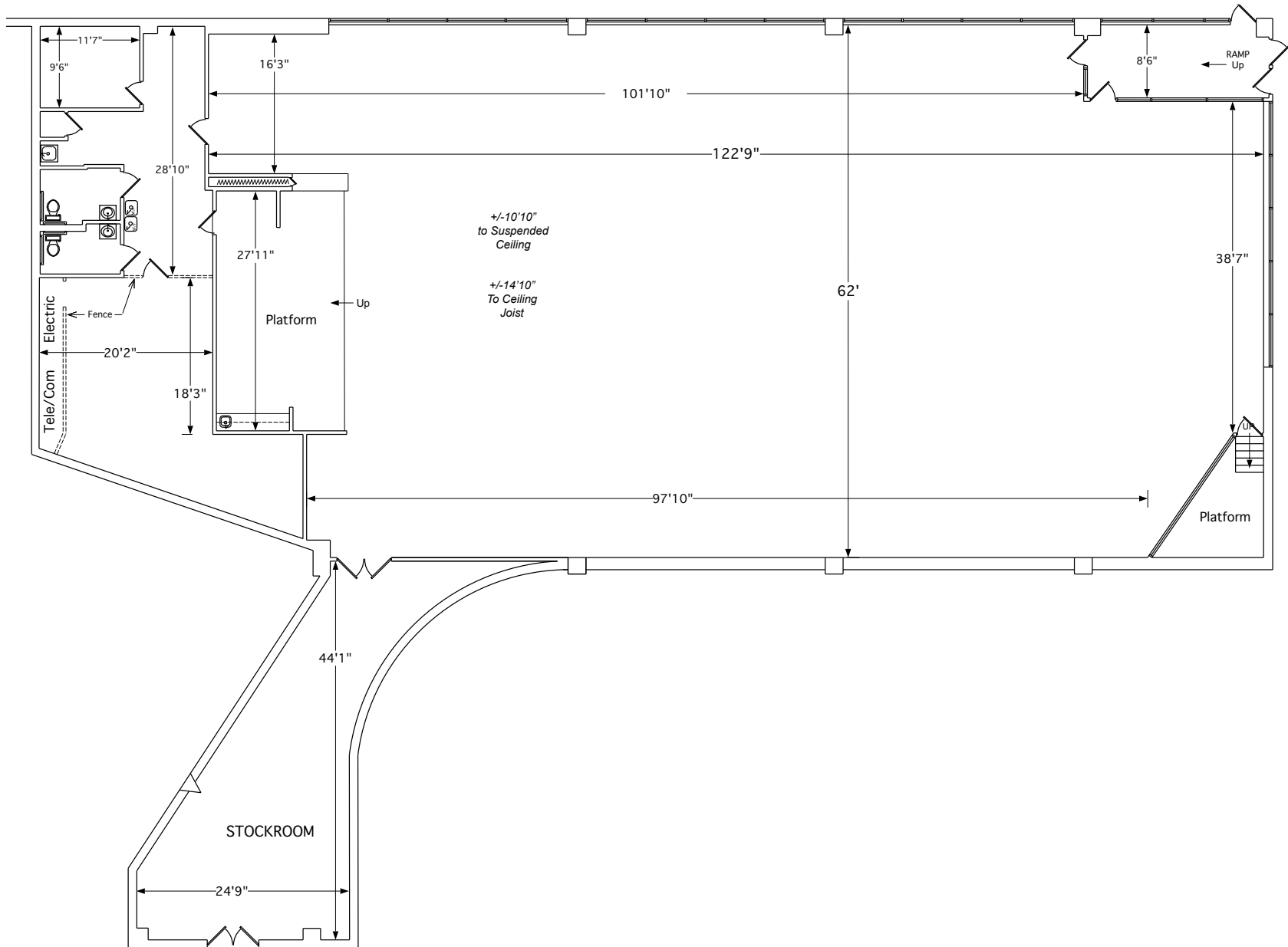

AERIAL

15TH STREET

BROAD STREET

13TH STREET

12TH STREET

11TH STREET

10TH STREET

9TH STREET

8TH STREET

7TH STREET

6TH STREET

5TH STREET

SOUTH STREET

BAINBRIDGE STREET

FITZWATER STREET

CATHARINE STREET

CHRISTIAN STREET

CARPENTER STREET

WASHINGTON AVENUE

An aerial map of a city grid, oriented with streets running diagonally. The map is overlaid with a grid of white lines representing streets. The streets are labeled with their names in red text: 15TH STREET, BROAD STREET, 13TH STREET, 12TH STREET, 11TH STREET, 10TH STREET, 9TH STREET, 8TH STREET, 7TH STREET, 6TH STREET, and 5TH STREET along the top; SOUTH STREET, BAINBRIDGE STREET, FITZWATER STREET, CATHARINE STREET, CHRISTIAN STREET, CARPENTER STREET, and WASHINGTON AVENUE along the left side. A prominent red shield-shaped marker with the word 'SITE' in white is located on 11th Street, between South Street and Bainbridge Street. The map is populated with numerous logos for various businesses, including: ACME, WHOLE FOODS, EXON, PNC, Bank of America, Starbucks, CITIZENS BANK, PHILADELPHIA'S MAGIC GARDEN, SOUTHWEST LOFTS, LISALAS PRONTO, skin house, ACME, WHOLE FOODS, SHERWIN-WILLIAMS, EXON, PHILADELPHIA'S MAGIC GARDEN, PNC, Bank of America, CITIZENS BANK, Starbucks, CHAPTERHOUSE GREE STUMP, FITZWATER CAFE, FITZWATER CAFE, SALOON, FLEISHER, RITE AID, PNC, >OWIE, ESSENCE, PNC, HAWTHORNES beer + cafe, FEARLESS ATHLETICS, Dante & Luigi's, MARRIOTT, FITZWATER CAFE, RITE AID, SALOON, FLEISHER, RITE AID, PNC, >OWIE, ESSENCE, PNC, CAPAHigh, SPRIGS, CHASE, TARGET, PETSMART, U-HAUL, Level, FANTO'S KITCHEN SHOP, ANASTASI, JOHN'S, ROYAL TAVERN, BEGGAR'S BROTHER, and many others. The map also shows a large green rectangular area on 10th Street, between South Street and Bainbridge Street, and a diagonal street labeled 'PASSUNK AVE' on the right side.



MSC

JON KIESERMAN

jkieserman@hellomsc.com

215.883.7377