

UNION SQUARE – RETAIL FOR SUBLEASE

731 MARKET STREET

SAN FRANCISCO, CALIFORNIA



KAZUKO MORGAN

Executive Vice Chairman
Lic. 01070005
kazuko.morgan@cushwake.com
+1 415 773 3546

HEATHER TRIMBLE

Director
Lic. 02041605
heather.trimble@cushwake.com
+1 415 485 3779



OVERVIEW

731 Market Street positions you in the midst of iconic landmarks and attractions. From the vibrant shops and sights of the Union Square district to captivating theater and arts, the "City by the Bay" offers both excitement and tradition. 735 Market Street is a prime retail location in close proximity to Union Square, Financial District, South Financial District, South of Market and the highly trafficked Moscone Center and Yerba Buena, which attracts both locals and tourists alike.

Renowned as an international shopping destination, Union Square is surrounded by fine dining, and live theater. The daytime population of both Union Square and the Downtown Financial District exceeds 1.1 million people. Day visitors and 23.1 million tourists visited San Francisco in 2023 and spent over \$8.8 billion in the city. Of all the hotel rooms in San Francisco, approximately 7,000+ are within walking distance to 731 Market.

This exciting retail opportunity at 731 Market Street offers unlimited potential. This space will be an amenity to the neighboring Palace Hotel, Four Seasons Hotel, The Paramount Apartments and Ritz Carlton Residences as well as the many shoppers who flock to the area.

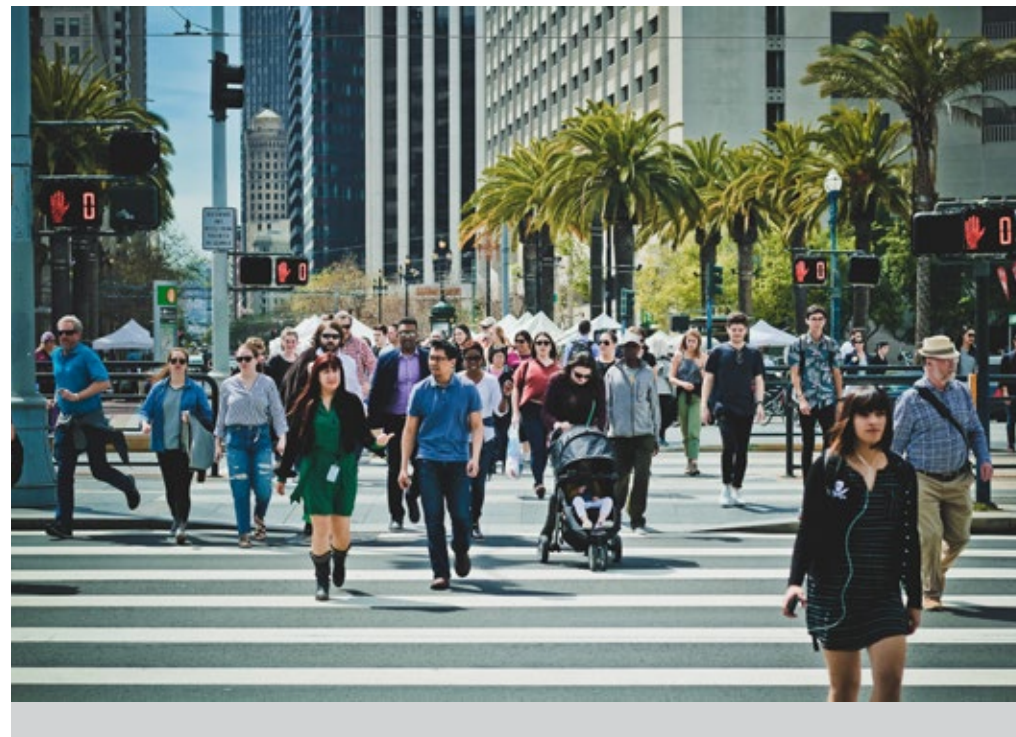

PREMISES

- ◆ 10,125 RSF
- ◆ Former CVS
- ◆ 55'-1" Frontage on Market Street
- ◆ Sublease through **12/31/30**
- ◆ In close proximity to public transportation, freeway and Bay Bridge

NEIGHBORING RETAILERS

Tropisueno, Ippudo, Delarossa, Amber India, Mixt, Feng Cha, Lemonade, Super Duper Burger, Chipotle, Target, Peet’s Coffee, Blue Bottle Coffee, Press Club, Equinox, Four Seasons Hotel and AMC Metreon



731 MARKET STREET

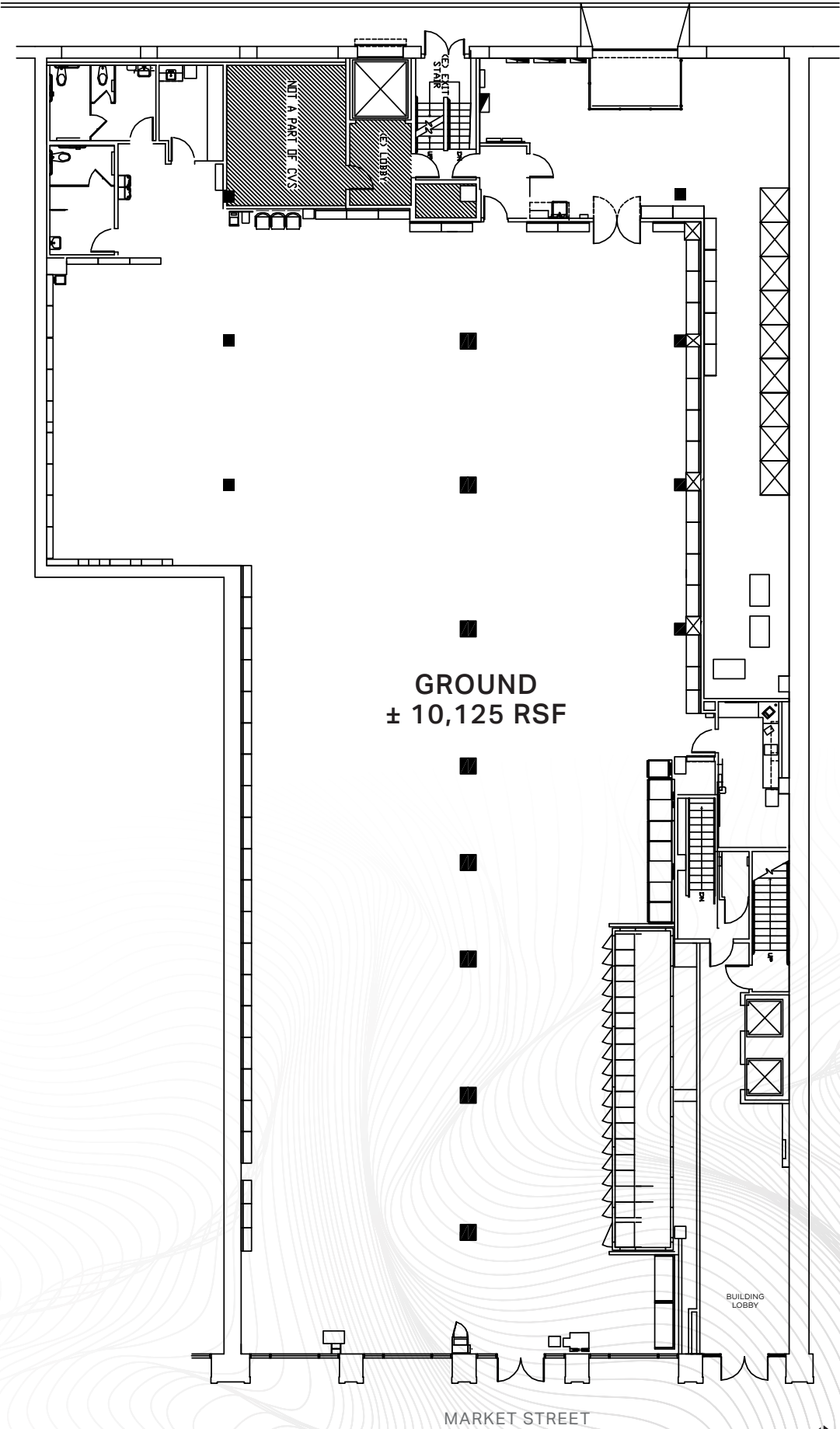

731 MARKET STREET

KEARNY STREET

CHASE

GNC

FedEx

Cafe Dolci

WELLS FARGO

GRANT AVENUE

verizon

STOCKTON STREET

Dr. Martens

POWELL STREET

FUTURE Jollibee

ABE'S PIZZA

MASON STREET

LINE

SERIF Dark Bar

RISE OVER RUN

ALFRED

Crazy Horse Gentlemen's Club

THE WARFIELD

TAYLOR STREET

MARKET STREET

3RD STREET

701

705

711

711B

721

FOR SUBLEASE

735

747

EQUINOX

757

FOUR SEASONS

757

767

YERBA BUENA LANE

773

785

ROSS

799

4TH STREET

801

815

825

845

845

845

865

865

865

865

865

865

865

865

5TH STREET

901

923

925

929

945

945

945

973

979

991

6TH STREET

731 MARKET STREET

NEIGHBORS

FOUR SEASONS HOTEL

MOSCONE CENTER

SF MOMA

CONTEMPORARY JEWISH MUSEUM

MARRIOTT MARQUIS

RITZ CARLTON RESIDENCES

PALACE HOTEL

CHOTTO MATTE

CUSHMAN & WAKEFIELD

731

MARKET STREET

SAN FRANCISCO, CALIFORNIA

UNION SQUARE – RETAIL FOR SUBLEASE



KAZUKO MORGAN

Executive Vice Chairman
Lic. 01070005
kazuko.morgan@cushwake.com
+1 415 773 3546

HEATHER TRIMBLE

Director
Lic. 02041605
heather.trimble@cushwake.com
+1 415 485 3779