

Mundelein | Former CVS Building

1101 West Maple Ave, Mundelein, IL (Rte 176 & Midlothian Rd)



OFFERING SUMMARY:

Building Size:	10,884 SF
Available SF:	10,884 SF
Building Class:	B
Lot Size:	1.36 AC
Year Built:	2005
Location:	NWC Route 176 & Midlothian Rd
Zoning:	C-2
Parking:	65 Surface Spaces
Traffic Count:	23,136 VPD

Mundelein | Former CVS Building

1101 West Maple Ave, Mundelein, IL (Rte 176 & Midlothian Rd)



AERIAL RETAIL MAP & DEMOGRAPHICS

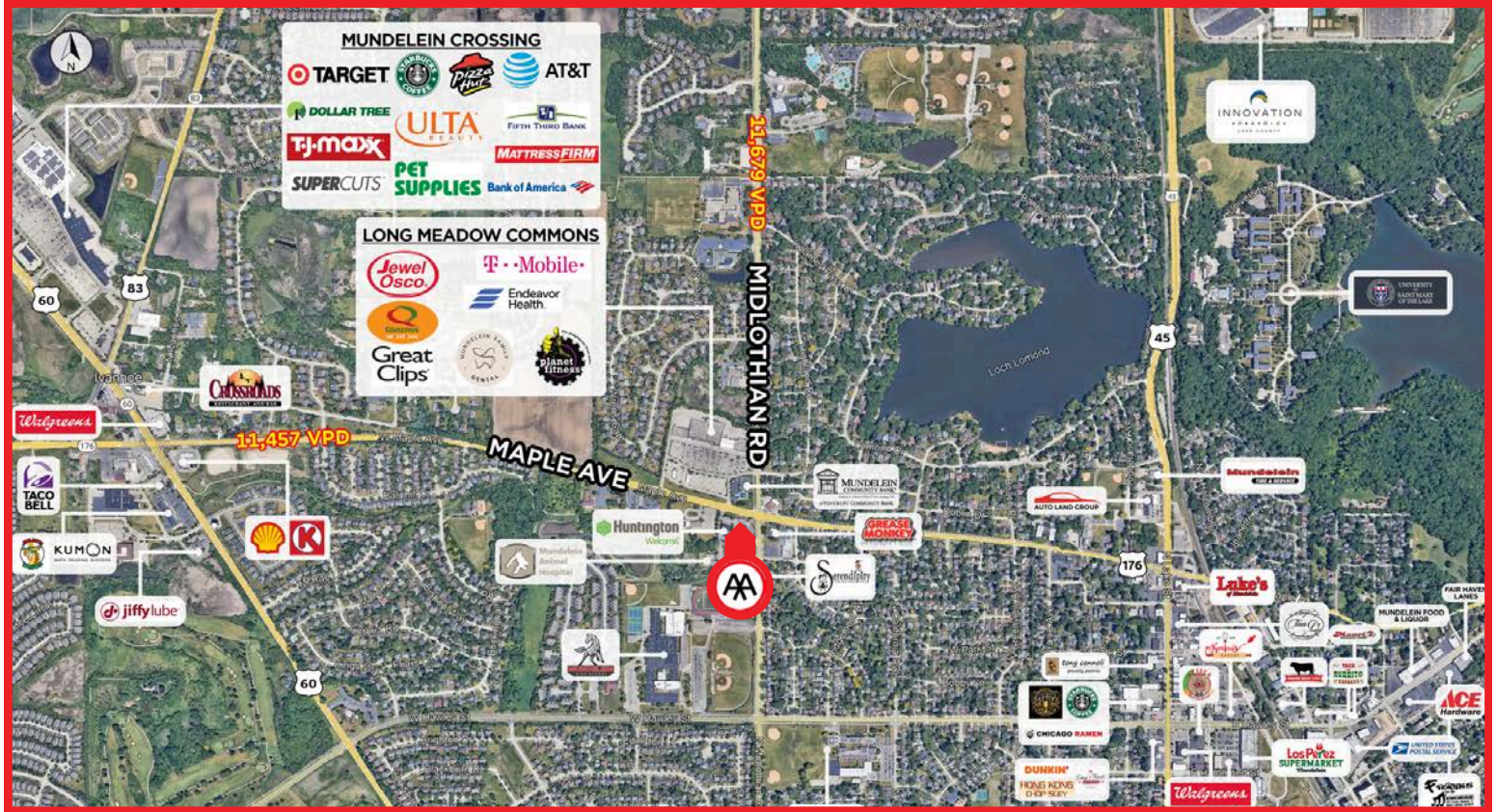

1 & 3 MILE DEMOGRAPHICS

	LAKE COUNTY	1 MILE	3 MILE
	Population	10,924	45,059
	2024 Households	3,862	15,730
	HH Income	\$125,299	\$142,534
	Daytime Employment	16,565	56,451



JOE SAUER

(M) 312.961.8748
joe@abell.com

TOM WALSH

(M) 847.421.4882
tom@abell.com

Mundelein | Former CVS Building

1101 West Maple Ave, Mundelein, IL (Rte 176 & Midlothian Rd)



BUILDING AERIAL & LOCATION MAP

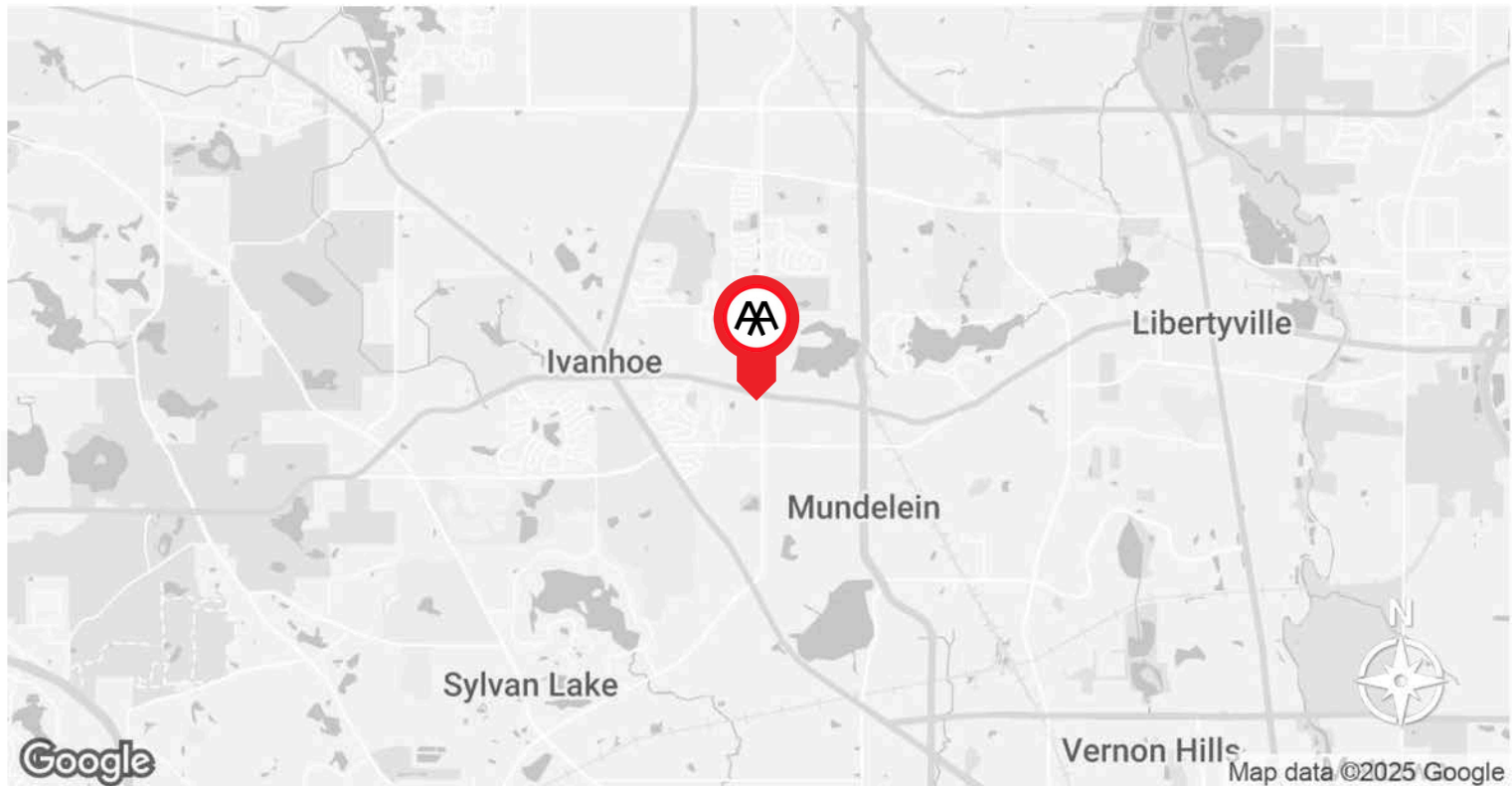

JOE SAUER

(M) 312.961.8748
joe@abell.com

TOM WALSH

(M) 847.421.4882
tom@abell.com

Mundelein | Former CVS Building

2075 South Lake Street, Mundelein IL (Rte 176 & Midlothian Rd)



PROPERTY SITE PLAN

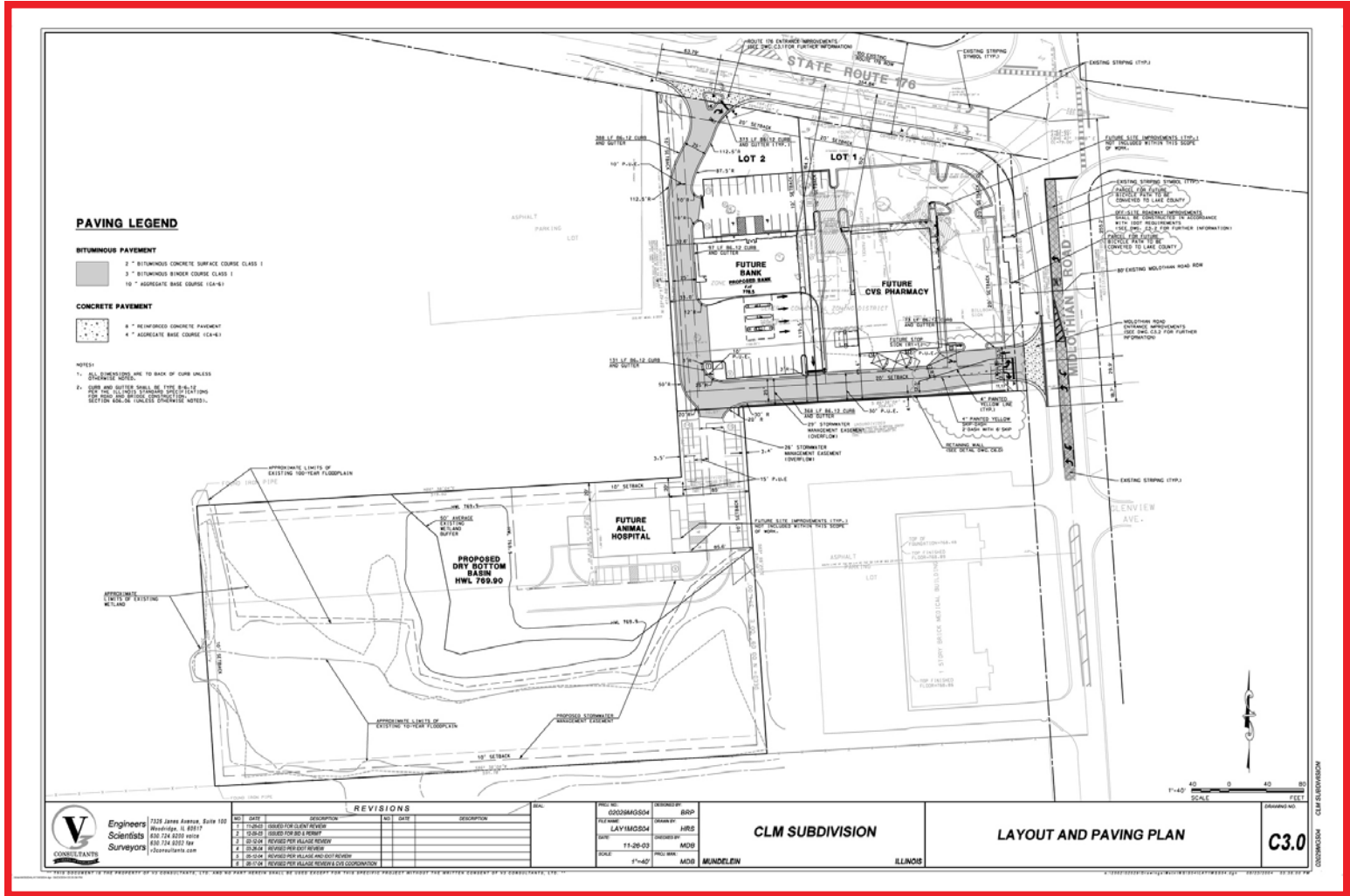

JOE SAUER
(M) 312.961.8748
joe@abell.com

TOM WALSH
(M) 847.421.4882
tom@abell.com

FOR MORE INFORMATION:



JOE SAUER
(M) 312.961.8748
joe@abbell.com

TOM WALSH
(M) 847.421.4882
tom@abbell.com