

Church Road 2 Acre Lot Next of CVS Drug Store

Getwell Rd, Southaven, MS 38672

MATTIACE



Philip Holman

The Mattiace Company
125 S Congress St, Suite 1800, Jackson, MS 39201
pholman@mattiace.com
(601) 352-1818

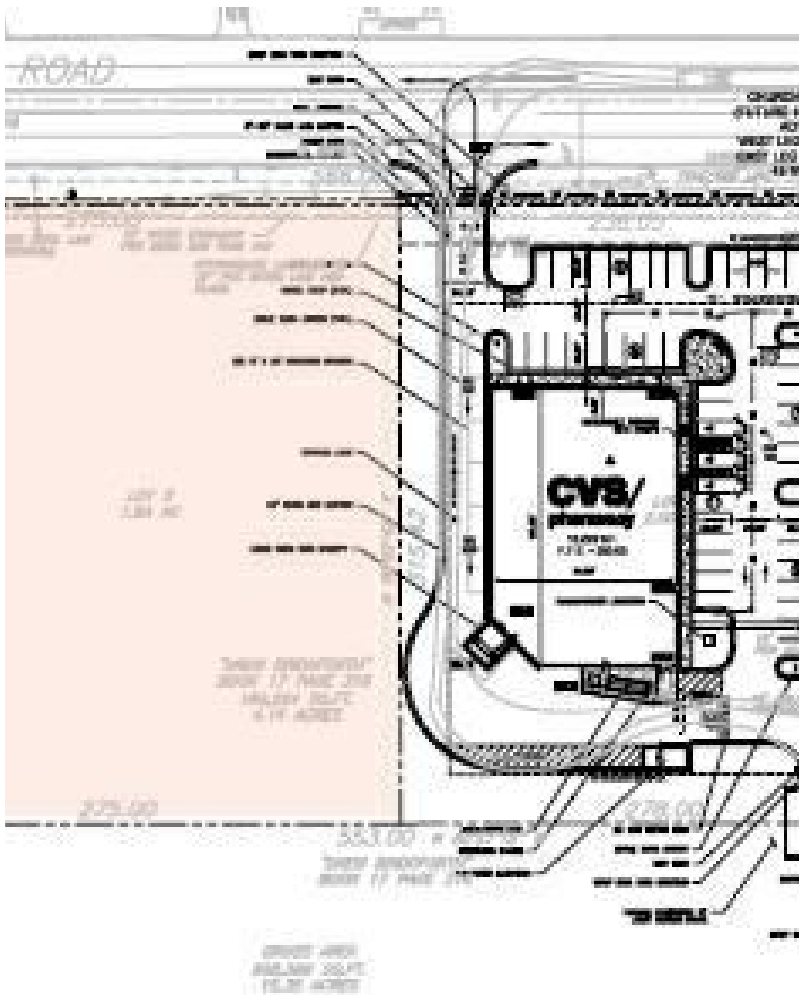

Church Road 2 Acre Lot Next of CVS Drug Store

Upon Request

2 Acre Lot Fronting Church Road located next to the CVS Drug Store located at the corner of Church and Getwell.

The vacant lot has 275 front feet on Church and is 316 feet deep....

Great opportunity for a Strip Center, Free Standing Retail Building or Restaurant, Medical or Office Building....

- 2 acre lot fronting Church Road
- Located next to the CVS Drug Store that is located on the corner of Church & Getwell
- Great location for Retail, Restaurant, Medical or Office.
- Area Retailers - Kroger, Target, Academy Sports, Hobby Lobby, Wal Mart, Wal Greens, Home Depot, Lowe's
- Church Road 19,000 CPD - Getwell Road 20,000 CPD



Price:	Upon Request
Property Type:	Land
Property Subtype:	Commercial
Proposed Use:	Commercial
Sale Type:	Investment or Owner User
Total Lot Size:	2.00 AC
No. Lots:	1
Zoning Description:	Commercial
APN / Parcel ID:	2072091300000200



Getwell Rd, Southaven, MS 38672

2 Acre Lot Fronting Church Road located next to the CVS Drug Store located at the corner of Church and Getwell.
The vacant lot has 275 front feet on Church and is 316 feet deep.