



Davies Pacific Center

841 Bishop St
Honolulu, HI 96813

Visible 9,077 SF Retail
Space Opportunity in
Central Business District
for Sublease



220 S. King Street, Suite 1800
Honolulu, Hawaii 96813
808 524 2666
colliers.com

Kelli Yanagawa Wilinski (S)

Vice President
Retail Services Division
Lic# RS-62770
808 371 4856
kelli.wilinski@colliers.com

Jon-Eric Greene (B)*

Senior Vice President
Retail Services Division
Lic# RS-17777
808 330 2900
jon-eric.greene@colliers.com

*Greene Property Group, LLC. Exclusively contracted to Colliers International HI, LLC. This document/email has been prepared by Colliers for advertising and general information only. Colliers makes no guarantees, representations or warranties of any kind, expressed or implied, regarding the information including, but not limited to, warranties of content, accuracy and reliability. Any interested party should undertake their own inquiries as to the accuracy of the information. Colliers excludes unequivocally all inferred or implied terms, conditions and warranties arising out of this document and excludes all liability for loss and damages arising there from. This publication is the copyrighted property of Colliers and /or its licensor(s). © 2022. All rights reserved. This communication is not intended to cause or induce breach of an existing listing agreement.

Property Overview

Area	Central Business District
TMK	(1) 2-1-14-1
Zoning	BMX-4
Available Space	9,077 SF (Ground Floor)
Base Rent	Negotiable
CAM	\$5,698.78/Month
Real Property Tax	\$2,975.05/Month
Sublease Term	Through December 31, 2028
Total Building Size	364,900 SF

Space Description

This ground floor 9,077 SF retail opportunity is located on a busy corner and surrounded by Class A office buildings. Enjoy Bishop Street visibility and walking convenience to downtown Honolulu's residential, office, hotel and retail properties. The space is clean, wide open and ready for occupancy!



Site Plan

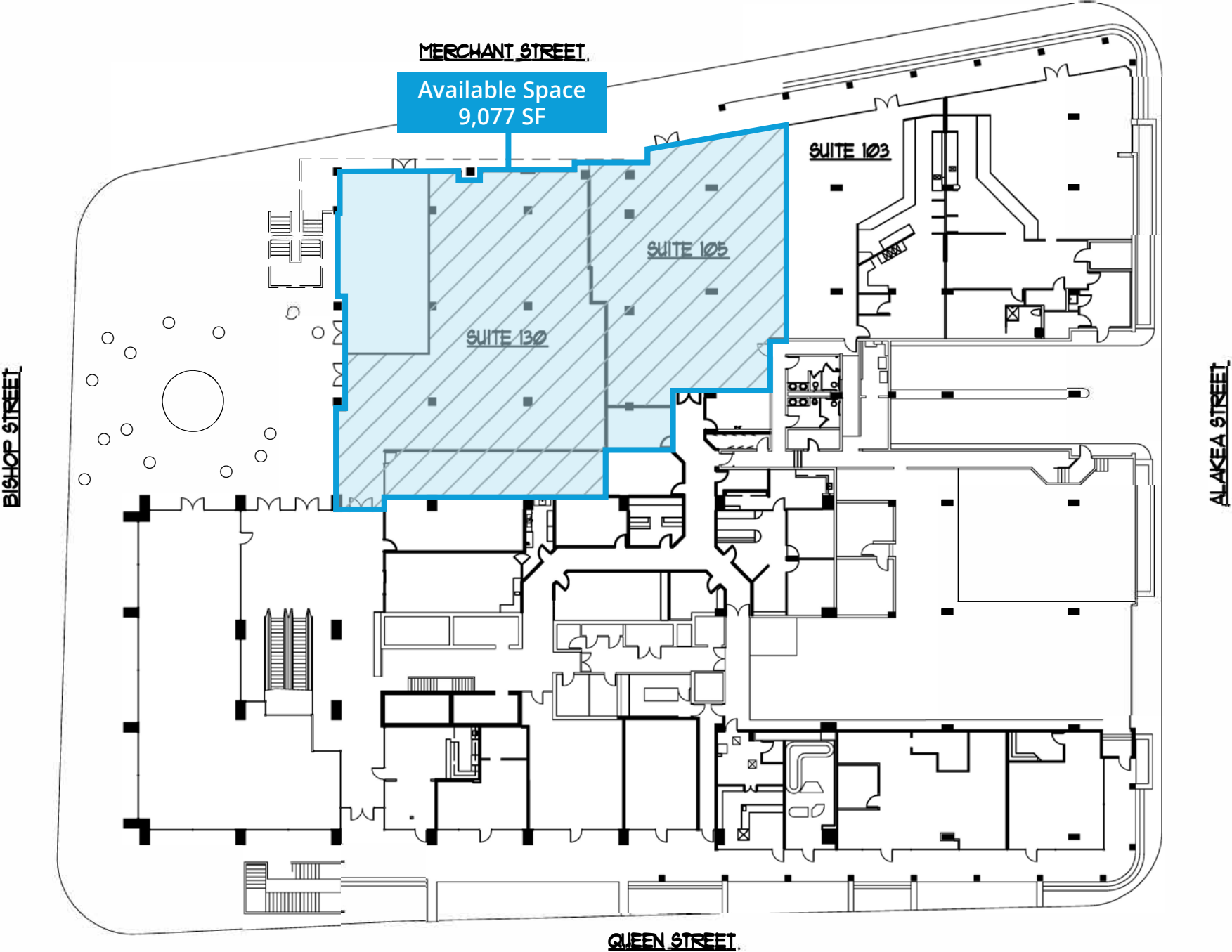



Contact Us:

Kelli Yanagawa Wilinski (S)

Vice President
Retail Services Division
Lic# RS-62770
808 371 4856
kelli.wilinski@colliers.com

Jon-Eric Greene (B)*

Senior Vice President
Retail Services Division
Lic# RS-17777
808 330 2900
jon-eric.greene@colliers.com

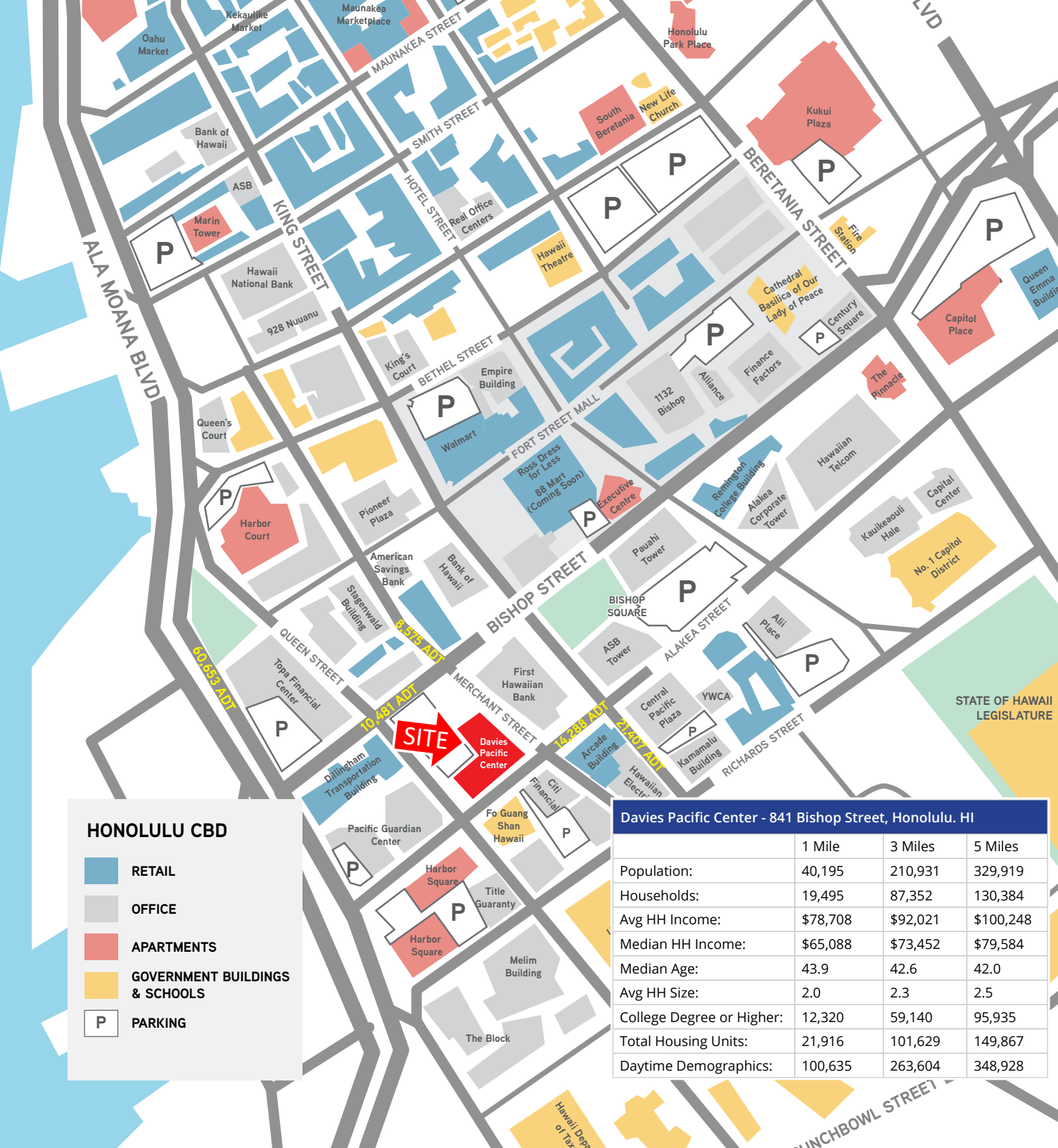

Davies Pacific Center - 841 Bishop Street, Honolulu, HI			
	1 Mile	3 Miles	5 Miles
Population:	40,195	210,931	329,919
Households:	19,495	87,352	130,384
Avg HH Income:	\$78,708	\$92,021	\$100,248
Median HH Income:	\$65,088	\$73,452	\$79,584
Median Age:	43.9	42.6	42.0
Avg HH Size:	2.0	2.3	2.5
College Degree or Higher:	12,320	59,140	95,935
Total Housing Units:	21,916	101,629	149,867
Daytime Demographics:	100,635	263,604	348,928

*Greene Property Group, LLC. Exclusively contracted to Colliers International HI, LLC. This document/email has been prepared by Colliers for advertising and general information only. Colliers makes no guarantees, representations or warranties of any kind, expressed or implied, regarding the information including, but not limited to, warranties of content, accuracy and reliability. Any interested party should undertake their own inquiries as to the accuracy of the information. Colliers excludes unequivocally all inferred or implied terms, conditions and warranties arising out of this document and excludes all liability for loss and damages arising there from. This publication is the copyrighted property of Colliers and /or its licensor(s). © 2022. All rights reserved. This communication is not intended to cause or induce breach of an existing listing agreement.

HONOLULU CBD

- RETAIL
- OFFICE
- APARTMENTS
- GOVERNMENT BUILDINGS & SCHOOLS
- P PARKING